



EVACUATION SYSTEM

Ditch the Air Horn

WES3 Wireless Evacuation and Emergency System.

WES3 is a fully customizable wireless system that has been developed to provide a simple, fast and secure method of communicating fire and medical emergencies in the complex environmental conditions of construction sites.

- **Completely wireless** battery operated system
- **Simple to install**, use and maintain
- **Manual push button** for fire and medical emergencies
- **Powerful 94dB horn** and bright strobe lights when activated
- **Full 4G connectivity** enabling off-site communications
- **Easily integrate** into third party systems on-site
- **Remote monitoring** via REACT

+1 (917) 822-8655
solutions@ramtechglobal.com





Protecting people and property on your construction site is vital.

Raise a fire or evacuation alarm by simply pressing any call point in the network, this will initiate a site-wide alarm or activate the pre-alarm function. The Control unit will notify the user of the exact location where the alarm has been triggered for quick identification.



Raise a medical alert by holding **B** for 2 seconds



Raise a fire emergency by pressing the manual call button

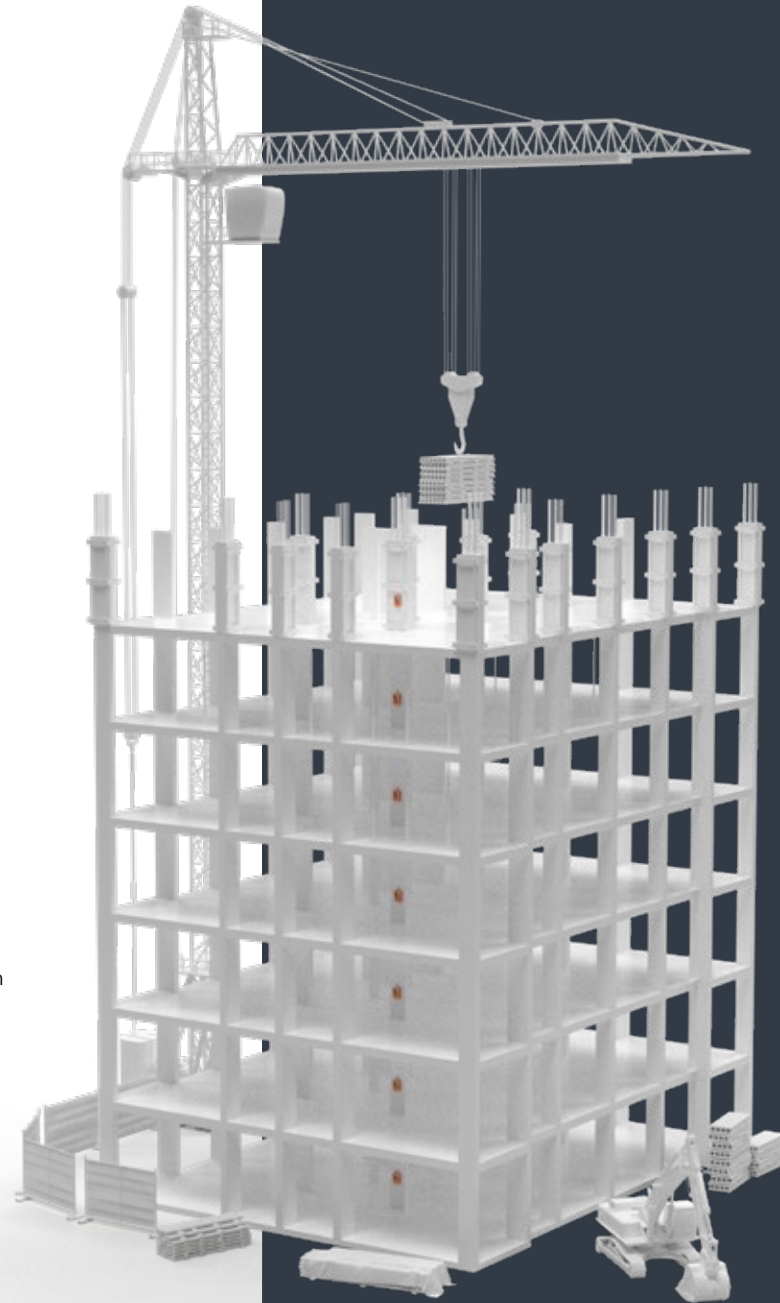

EVACUATION SYSTEM